



TAIWAN WINCH



sunwins

ELECTRIC HOIST

TRUE VALUE FOR HIGH
QUALITY ELECTRIC HOIST



ELECTRIC HOIST

TRUE VALUE FOR HIGH

QUALITY ELECTRIC HOIST

JV



ELECTRIC HOIST

JC



ELECTRIC HOIST

ME



MINI WINCH

RC



ELECTRIC HOIST

MR



MINI WINCH

PU



ELECTRIC HOIST

CH

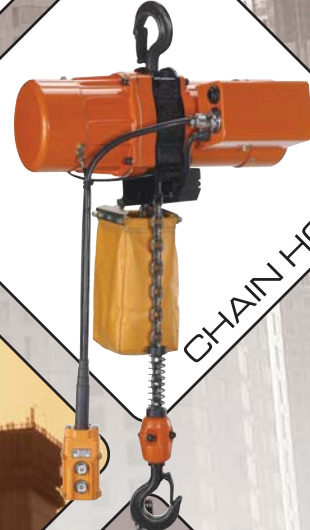

CHAIN HOIST

01



LEADERSHIP THROUGH PERFORMANCE

A single source for high quality electric hoists.

TAIWAN WINCH® A DEPENDABLE BRAND NAME IN HIGH QUALITY ELECTRIC HOIST

Taiwan Winch® Industrial Co.,Ltd is a highly reputed manufacturer of various electric hoist. Based on our outstanding R&D capability and extensive experience, we have designed and manufactured the most comprehensive electric hoists for application in construction, household, store and factory, etc. At **Taiwan Winch®**, we have a strong commitment to provide the best possible electric hoists for our customers. To this end, we will constantly strive hard for pursuing a higher level of quality and performance for each electric hoist.

RESEARCH AND DEVELOPMENT

Taiwan Winch® electric hoist have been sold and recognized by customers in domestic and many countries in the world. One reason for the excellence of **Taiwan Winch®** products comes from our total dedication to technological research and development. Our R&D staffs not only constantly develop new electric hoists to meet the market demands, but also continuously improve our existed hoists to achieve a higher level of performance. Our objective is to enhance each electric hoist from **Taiwan Winch®** will provide the best possible performance and efficiency.



RIGOROUS QUALITY CONTROL FROM BEGINNING TO FINISH

Insisting on quality has been a tradition at **Taiwan Winch®** since the company was established. We employ total quality control system to thoroughly control quality during each stage of the hoist manufacturing process. Rigorous and comprehensive quality inspection are conducted before shipment, which ensure each product from **Taiwan Winch®** will provide outstanding quality and maximum dependability.

ELECTRIC HOIST

LIFTING CAPACITY 200 KG / 300 KG

Single / Three Phase Motor

TW-200 TW-300



MODEL :	TW-200		TW-300	
Lifting Capacity	200 KG		300 KG	
Steel Rope	6 mm x 30 M		6 mm x 30 M	
Motor	0.5 Kw		0.75 Kw	
Voltage	1 PH 220 V		1 PH 220 V	
	60 HZ	50 HZ	60 HZ	50 HZ
Speed	13 M/min	11 M/min	13 M/min	11 M/min
Packing	L535 x W270 x H325(mm)		L600 x W270 x H325(mm)	
Net Weight	29.7 KG		33.6 KG	
Gross Weight	31.1 KG		35.0 KG	

VOLTAGE : 3 PH 220/380/440 V available

DIMENSIONS

unit: mm

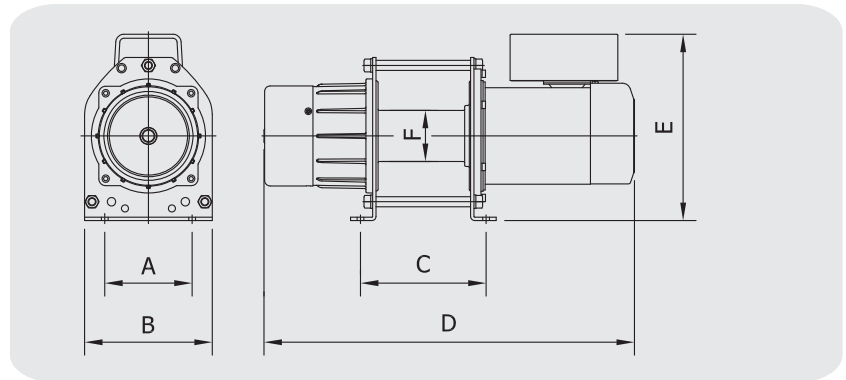

TW - 200	A:142	B:210	C:142	D:474	E:265	F:76
TW - 300	A:142	B:210	C:142	D:486	E:265	F:76

03

LIFTING CAPACITY 500 KG

Single / Three Phase Motor

TW-500 TC07-50



MODEL :	TW-500		TC07-50	
Lifting Capacity	500 KG		500 KG	
Steel Rope	8 mm x 30 M		8 mm x 50 M	
Motor	1.60 Kw		1.80 Kw	
Voltage	1 PH 220 V		1 PH 220 V	
	60 HZ	50 HZ	60 HZ	50 HZ
Speed	16 M/min	13 M/min	21 M/min	18 M/min
Packing	L685 x W270 x H325(mm)		L710 x W270 x H325(mm)	
Net Weight	47.1 KG		57.4 KG	
Gross Weight	48.7 KG		59.0 KG	

VOLTAGE : 3 PH 220/380/440 V available

DIMENSIONS

unit: mm

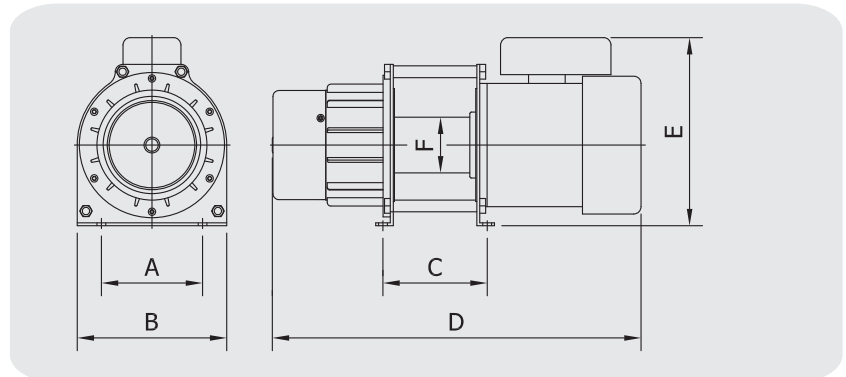

TW - 500	A:160	B:220	C:186	D:626	E:288	F:78
TC07-50	A:160	B:250	C:206	D:661	E:295	F:105

LIFTING CAPACITY 500 KG

Single / Three Phase Motor

F08-50 S08-100



MODEL :	F08-50		S08-100	
Lifting Capacity	500 KG		1000 KG	
Steel Rope	8 mm x 100 M		10 mm x 60 M	
Motor	2,00 Kw		3,70 Kw	
Voltage	1 PH 220 V		3 PH 220 V	
	60 HZ	50 HZ	60 HZ	50 HZ
Speed	25 M/min	21 M/min	25 M/min	21 M/min
Packing	L800 x W297 x H370(mm)		L800 x W297 x H325(mm)	
Net Weight	91.5 KG		100 KG	
Gross Weight	93.5 KG		102 KG	

VOLTAGE : 3 PH 220/380/440 V available

DIMENSIONS

unit: mm

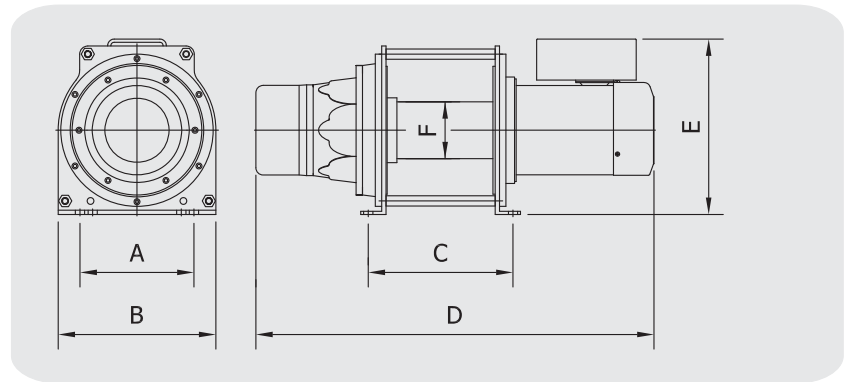

F08-50	A:202	B:292	C:265	D:751	E:328	F:101
S08-100	A:202	B:292	C:265	D:757	E:343	F:101

LIFTING CAPACITY 1000 KG

Single / Three Phase Motor

PU-1100-05H06



MODEL : PU-1100-05H06

Lifting Capacity	1000 KG	
Steel Rope	10 mm x 60 M	
Motor	1,30 Kw	
Voltage	1 PH 220 V	
	60 HZ	50 HZ
Speed	5 M/min	4 M/min
Net Weight	86.5 KG	
Gross Weight	88 KG	

VOLTAGE : 3 PH 220/380/440 V available

DIMENSIONS

unit: mm

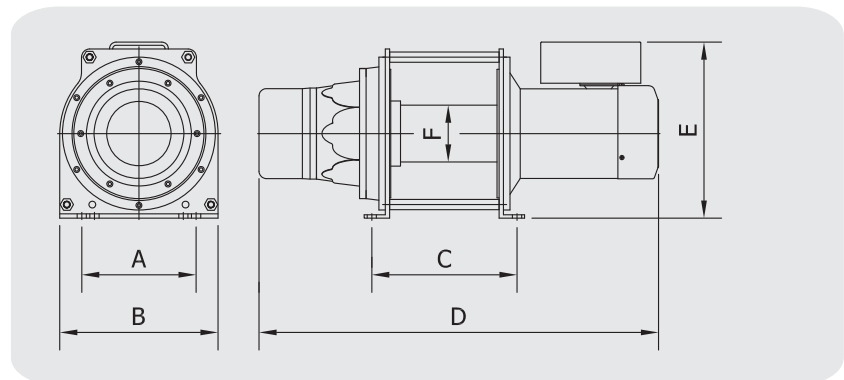

PU-1100-05H06	A:202	B:292	C:265	D:783	E:345	F:101
----------------------	-------	-------	-------	-------	-------	-------

• The above specifications subject to change without prior notice.

ELECTRIC CHAIN HOIST



unit: mm

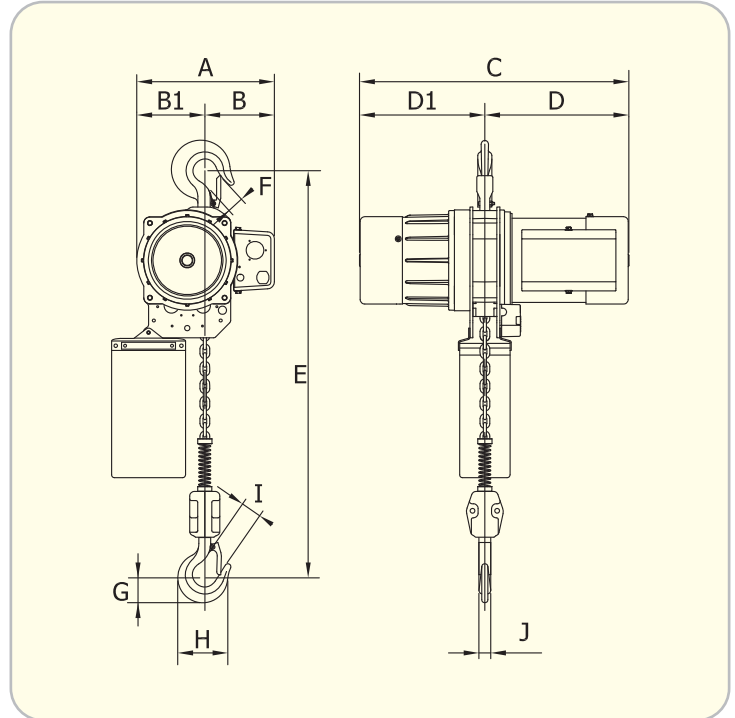

05

FEATURES

- Employs imported FEC80 class high strength heat treated alloy steel chain.
- **LIMIT SWITCH POSITIONS:**
Limit switches are provided at lift-up and down stroke to prevent poor smoothness of chain or loosening while ensuring safety.
- **24V LOW VOLTAGE DEVICE:**
In case electric shock from switch, the low voltage device may avoid accident.
- Specially designed DC magnetic brake.
- Upon request, additional electronic overload protector and emergency stop switch.
- In case of power failure, the DC magnetic brake actuates immediately.

SPECIFICATIONS

Model	Capacity (KGS)	LIFT (M)	Hoisting Speed (M/min)		Hoisting Motor (KW)
			50HZ	60HZ	
CH-1102-10A03	250KG	3	8.9	10.7	0.55
CH-1105-06A03	500KG		5	6.1	0.55
CH-1105-10A03	500KG		8.9	10.7	0.75
CH-1110-06B03	1000KG		5	6.1	0.75
CH-1220-03B03	2000KG		2.5	3	0.75

Model	Capacity (KGS)	LIFT (M)	Hoisting Speed (M/min)		Hoisting Motor (KW)
			50HZ	60HZ	
CH-3102-10A03	250KG	3	8.9	10.7	0.55
CH-3105-06A03	500KG		5	6.1	0.55
CH-3105-10A03	500KG		8.9	10.7	0.75
CH-3110-06B03	1000KG		5	6.1	0.75
CH-3220-03B03	2000KG		2.5	3	0.75

Product specifications and features are subject to change as a result of technological progress without prior notice.
Three phase motor is available.

MODEL NUMBER IDENTIFICATION

CH - 1 1 05 - 04 B 03

CH :
Chain type

Phase
1: Single phase
3: Three phase

Safety lifting capacity
02=250KG
05=500KG
10=1000KG

Chain diameter
A : 6.3mm x 19 Pitch
B : 7.1mm x 21Pitch
C : 10.0mm x 30 Pitch
D : 11.2mm x 34 Pitch

Load chain fall lines
1: Single chain
2: Double chain

Average lifting speed

Steel rope length
03=3M
05=5M
10=10M

Chain Dia x Pitch	Load Chain Fall Lines	Power Source	N.W. (KG)	G.W. (KG)	Approx. Dimensions (mm)											Packing (L x W x H) (mm)	
					A	B	C	D	E	F	G	H	I	J	B1		D1
FEC Ø6.3 X 19	1	SINGLE PHASE 220V ~ 240V	34	35	235	119	445	231	520	31	42.5	85	31	20	116	214	478 x 372 x 275
FEC Ø6.3 X 19			34	35	235	119	445	231	520	31	42.5	85	31	20	116	214	
FEC Ø6.3 X 19			34	35	235	119	460	246	520	31	42.5	85	31	20	116	214	
FEC Ø7.1 X 21			35	36	235	119	460	246	520	31	42.5	85	31	20	116	214	
FEC Ø7.1 X 21			2	44	45	235	119	460	246	520	31	42.5	85	31	20	116	

Chain Dia x Pitch	Load Chain Fall Lines	Power Source	N.W. (KG)	G.W. (KG)	Approx. Dimensions (mm)											Packing (L x W x H) (mm)	
					A	B	C	D	E	F	G	H	I	J	B1		D1
FEC Ø6.3 X 19	1	THREE PHASE 220V ~ 440V	34	35	235	119	445	231	520	31	42.5	85	31	20	116	214	478 x 372 x 275
FEC Ø6.3 X 19			34	35	235	119	445	231	520	31	42.5	85	31	20	116	214	
FEC Ø6.3 X 19			34	35	235	119	460	246	520	31	42.5	85	31	20	116	214	
FEC Ø7.1 X 21			35	36	235	119	460	246	520	31	42.5	85	31	20	116	214	
FEC Ø7.1 X 21			2	44	45	235	119	460	246	520	31	42.5	85	31	20	116	

TAIWAN WINCH INDUSTRIAL CO.,

MODEL NUMBER IDENTIFICATION

JV - 1 170

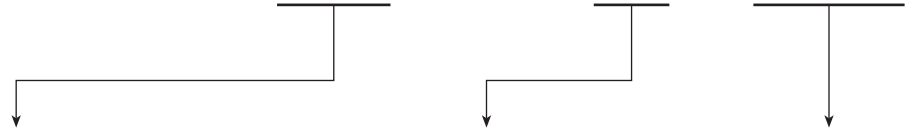

	MR Series
	ME Series
	JV Series
	JC Series
	RC Series
	PU Series

Voltage

- 1. 100 ~ 120V
- 2. 220 ~ 240V

Phase

- 1 (Single)
- 3 (Three)

Safety lifting capacity

- 170 = 170 KG
- 200 = 200 KG
- 230 = 230 KG
- 260 = 260 KG
- 020 = 200 KG
- 025 = 250 KG
- 030 = 300 KG
- 040 = 400 KG
- 050 = 500 KG
- 070 = 700 KG
- 100 = 1000KG
- 120 = 1200KG
- 150 = 1500KG
- 200 = 2000KG
- 300 = 3000KG



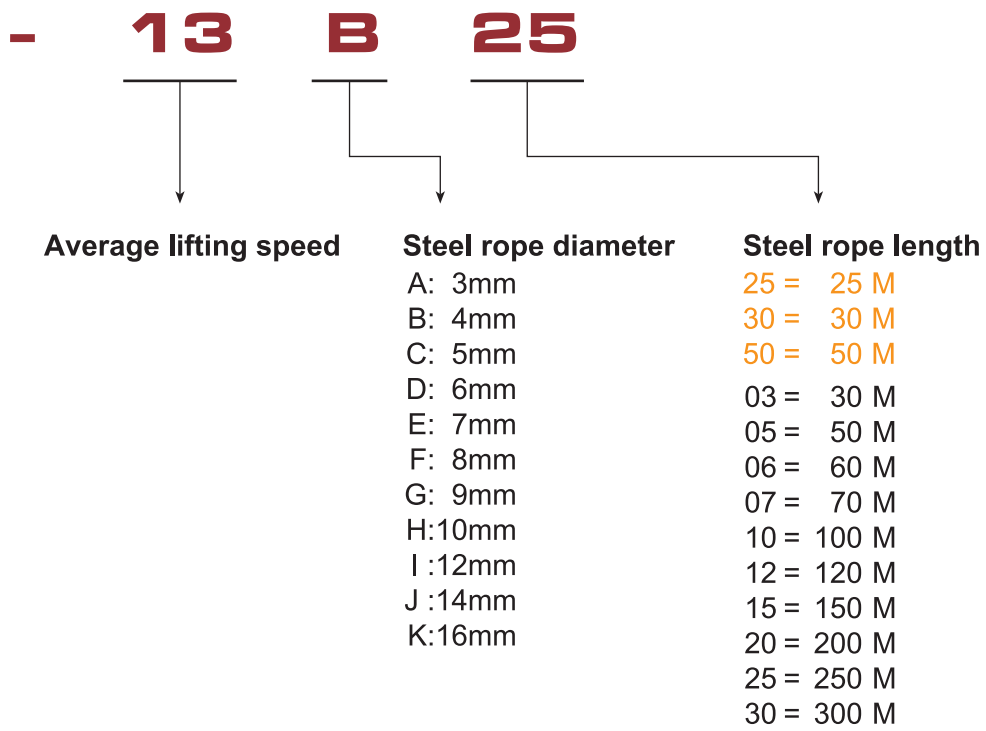



unit: mm

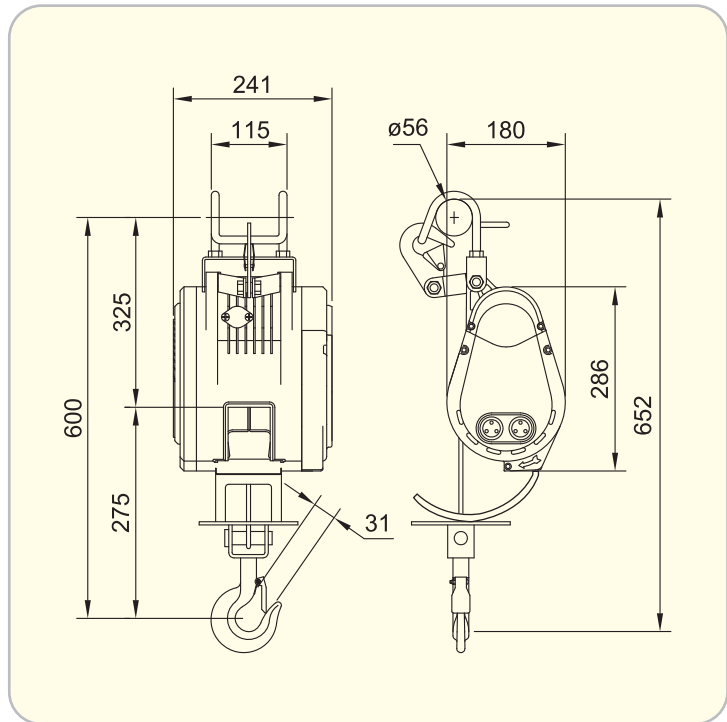

MR SERIES

09



MR Type Receptacle



Hoist Water Proof Push Button Pendant Switch with Emergency Stop

SPECIFICATIONS

Model	Lifting Capacity	Speed (M/min)	Power consumption	Rated Power Source	Steel Rope
MR-2085-28A50	85KG	28	1000W	5A	3mm x 50M
MR-2170-21B30	170KG	21	1200W	6A	4mm x 30M
MR-2200-15C30	200KG	15	1200W	6A	5mm x 30M
MR-2200-21C30	200KG	21	1300W	6.5A	
MR-2230-15C30	230KG	15	1200W	6A	
MR-2230-21C30	230KG	21	1300W	6.5A	
MR-2260-15C30	260KG	15	1300W	6.5A	
MR-2300-13C30	300KG	13	1300W	6.5A	

VOLTAGE : SINGLE PHASE 100 ~ 120V available

ME SERIES



ME Type Receptacle



Hoist Water Proof Push Button Pendant Switch

SPECIFICATIONS

Model	Lifting Capacity	Speed (M/min)	Power consumption	Rated Power Source	Steel Rope
ME-2085-28A50	85KG	28	1000W	5A	3mm x 50M
ME-2170-21B30	170KG	21	1200W	6A	4mm x 30M
ME-2200-15C30	200KG	15	1200W	6A	5mm x 30M
ME-2200-21C30	200KG	21	1300W	6.5A	
ME-2230-15C30	230KG	15	1200W	6A	
ME-2230-21C30	230KG	21	1300W	6.5A	
ME-2260-15C30	260KG	15	1300W	6.5A	
ME-2300-13C30	300KG	13	1300W	6.5A	

VOLTAGE : SINGLE PHASE 100 ~ 120V available

A compactly constructed winch designed for performance and economy.

FEATURES

- Compact and lightweight for easy handling. Low noise level
- Equipped with magnetic contactor to avoid voltage drop, while ensuring powerful lifting.
- Limit switches device can prevent steel rope reverse roll or over roll.
- The motor has specially designed with high starting torque
- 10 meters control wire and three point button with Emergency stop switch.
- Upon request, increase control wire length or to install the remote control is available.

Voltage	Rated reciprocation	Power wire	Operational cable	Control switch	N.W. (KG)	G.W. (KG)	Packing(L x W x H) (mm)
SINGLE PHASE 220~240V 50/60HZ	25% ED, 150 time/hour	5M	10M	2-button switch with Emergency Stop	19	20	427 x 245 x 345

Voltage	Rated reciprocation	Power wire	Operational cable	Control switch	N.W. (KG)	G.W. (KG)	Packing(L x W x H) (mm)
SINGLE PHASE 220~240V 50/60HZ	25% ED, 150 time/hour	5M	10M	2-button switch	19	20	427 x 245 x 345

Product specifications and features are subject to change as a result of technological progress without prior notice.

JV SERIES ELECTRIC HOIST

2 Planetary gears



DIMENSIONS

unit: mm

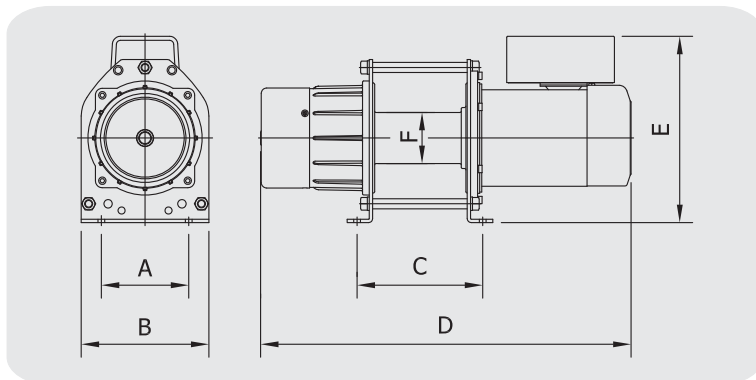

- High efficient planetary gear.
- Small body, great saving of mounting space.
- Light weight, convenient handling, easy to operate.
- Electromagnetic brake system, most reliable long term performance.
- Separated quick connection for convenience.
- Rigid construction, low noise level, long life time.

SPECIFICATIONS

Model	Lifting Capacity	Speed(M/min)		Steel Rope	Voltage	Motor (KW)	Body Dimensions(mm)						N.W. (KG)	G.W. (KG)	Packing (L x W x H) (mm)
		50HZ	60HZ				A	B	C	D	E	F			
JV-1020-13D03	200KG	11	13	6mm x 30M	SINGLE PHASE 220 ~ 240V	0.50	142	210	142	474	265	76	29.7	31.1	535 x 270 x 325
JV-1020-16D03	200KG	13	16	6mm x 30M		0.55	142	210	142	474	265	76	28.2	29.6	535 x 270 x 325
JV-1020-22D03	200KG	18	22	6mm x 30M		0.75	142	210	142	515	265	76	31.6	33.0	600 x 270 x 325
JV-1020-26D03	200KG	22	26	6mm x 30M		0.75	142	210	142	520	265	76	34.1	35.5	600 x 270 x 325
JV-1020-13D05	200KG	11	13	6mm x 50M		0.55	160	220	186	556	280	76	31.6	32.0	613 x 270 x 325
JV-1020-16D05	200KG	13	16	6mm x 50M		0.75	160	220	186	556	280	76	34.5	36.0	613 x 270 x 325
JV-1020-22D05	200KG	18	22	6mm x 50M		0.75	160	220	186	556	280	76	34.5	36.0	613 x 270 x 325
JV-1020-27D05	200KG	22	27	6mm x 50M		1.10	160	220	186	556	280	76	34.5	36.0	613 x 270 x 325
JV-1025-13D03	250KG	11	13	6mm x 30M		0.55	142	210	142	486	265	76	30.2	31.6	535 x 270 x 325
JV-1025-16D03	250KG	13	16	6mm x 30M		0.75	142	210	142	527	265	76	32.2	33.6	600 x 270 x 325
JV-1025-26D03	250KG	22	26	6mm x 30M		1.10	142	210	142	532	265	76	34.6	36.0	600 x 270 x 325
JV-1025-31D03	250KG	26	31	6mm x 30M		1.10	142	210	142	532	265	76	34.6	36.0	600 x 270 x 325
JV-1025-13D05	250KG	11	13	6mm x 50M		0.55	160	220	186	556	280	76	31.6	33.0	613 x 270 x 325
JV-1025-16D05	250KG	13	16	6mm x 50M		0.75	160	220	186	556	280	76	34.5	36.0	613 x 270 x 325
JV-1025-27D05	250KG	22	27	6mm x 50M		1.10	160	220	186	556	280	76	34.5	36.0	613 x 270 x 325
JV-1025-32D05	250KG	26	32	6mm x 50M		1.30	160	220	186	556	280	76	36.5	38.0	613 x 270 x 325
JV-1030-13D03	300KG	11	13	6mm x 30M		0.75	142	210	142	527	265	76	33.6	35.0	600 x 270 x 325
JV-1030-16D05	300KG	13	16	6mm x 50M		1.10	160	220	186	556	280	76	38.3	39.7	613 x 270 x 325
JV-1030-16E04	300KG	13	16	7mm x 40M		1.10	160	220	186	556	280	76	38.6	40.0	613 x 270 x 325
JV-1030-16F03	300KG	13	16	8mm x 30M		1.10	160	220	186	556	280	76	37.6	39.0	613 x 270 x 325
JV-1030-26D03	300KG	22	26	6mm x 30M	1.30	142	210	142	550	265	76	36.6	38.0	600 x 270 x 325	
JV-1030-29D05	300KG	24	29	6mm x 50M	1.60	160	220	186	600	288	76	37.8	46.2	642 x 270 x 325	
JV-1030-29E04	300KG	24	29	7mm x 40M	1.60	160	220	186	600	288	76	46.5	48.0	642 x 270 x 325	
JV-1030-29F03	300KG	24	29	8mm x 30M	1.60	160	220	186	600	288	76	45.5	47.0	642 x 270 x 325	

Product specifications and features are subject to change as a result of technological progress without prior notice.
Three phase motor is available.

JC SERIES ELECTRIC HOIST

2 Planetary gears, with output shaft support

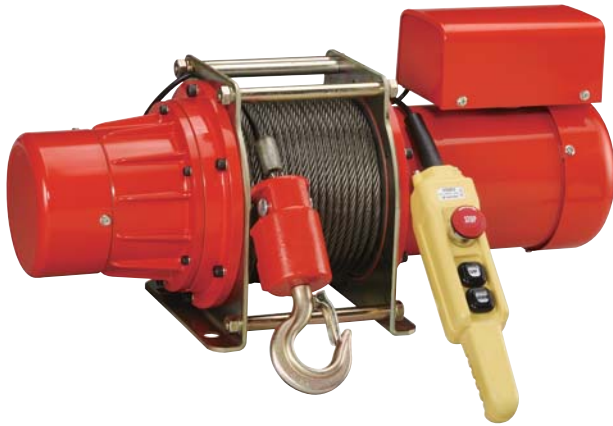

DIMENSIONS

unit: mm

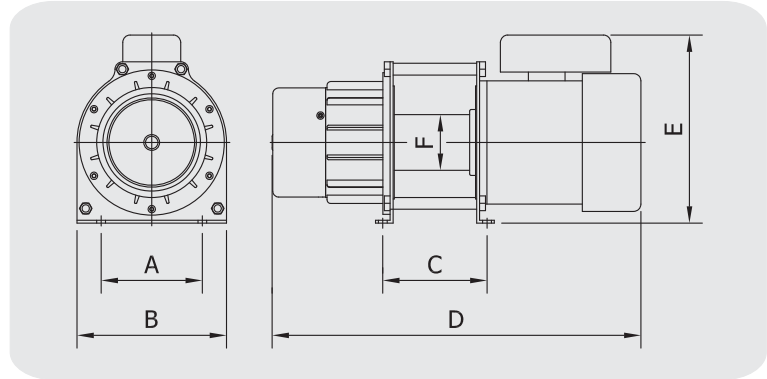

- High efficient planetary gear.
- Small body, great saving of mounting space.
- Light weight, convenient handling, easy to operate.
- Electromagnetic brake system, most reliable long term performance.
- Separated quick connection for convenience.
- Rigid construction, low noise level, long life time.

SPECIFICATIONS

Model	Lifting Capacity	Speed(M/min)		Steel Rope	Voltage	Motor (KW)	Body Dimensions(mm)						N.W. (KG)	G.W. (KG)	Packing (L x W x H) (mm)
		50HZ	60HZ				A	B	C	D	E	F			
JC-1020-13D05	200KG	11	13	6mm x 50M	SINGLE PHASE 220 ~ 240V	0.55	160	220	186	557	280	78	37.2	39.0	685 x 270 x 325
JC-1020-26D05	200KG	22	26	6mm x 50M		1.1	160	220	186	603	280	78	45.2	47.0	685 x 270 x 325
JC-1020-21D08	200KG	17	21	6mm x 80M		1.5	160	250	206	653	290	105	55.7	57.5	710 x 270 x 325
JC-1020-21D12	200KG	17	21	6mm x 120M		1.5	160	250	250	695	290	105	61.7	63.5	760 x 270 x 325
JC-1025-13D05	250KG	11	13	6mm x 50M		0.75	160	220	186	598	280	78	40.7	42.5	685 x 270 x 325
JC-1025-26D05	250KG	22	26	6mm x 50M		1.1	160	220	186	603	280	78	45.2	47.0	685 x 270 x 325
JC-1025-21D08	250KG	17	21	6mm x 80M		1.5	160	250	206	653	290	105	55.6	57.5	710 x 270 x 325
JC-1025-21D12	250KG	17	21	6mm x 120M		1.5	160	250	250	695	290	105	61.6	63.5	760 x 270 x 325
JC-1030-13E04	300KG	11	13	7mm x 40M		0.75	160	220	186	598	280	78	40.7	42.5	685 x 270 x 325
JC-1030-16E04	300KG	13	16	7mm x 40M		1.3	160	220	186	592	280	78	42.2	44.0	685 x 270 x 325
JC-1030-33E04	300KG	28	33	7mm x 40M		2.0	160	220	186	626	290	78	49.2	51.0	685 x 270 x 325
JC-1030-42E06	300KG	35	42	7mm x 60M		2.2	160	250	206	645	290	105	56.2	58.0	710 x 270 x 325
JC-1040-26F03	400KG	22	26	8mm x 30M		1.6	160	220	186	626	290	78	48.2	50.0	685 x 270 x 325
JC-1040-42F05	400KG	35	42	8mm x 50M		3.7	160	250	206	663	290	105	60.0	62.0	710 x 270 x 325
JC-1050-16F03	500KG	13	16	8mm x 30M		1.6	160	220	186	626	290	78	47.0	49.0	685 x 270 x 325
JC-1050-21F05	500KG	17	21	8mm x 50M		1.8	160	250	206	653	290	105	57.5	59.5	710 x 270 x 325

Product specifications and features are subject to change as a result of technological progress without prior notice.
Three phase motor is available.

RC SERIES ELECTRIC HOIST

3 Planetary gears, with output shaft support

DIMENSIONS

unit: mm

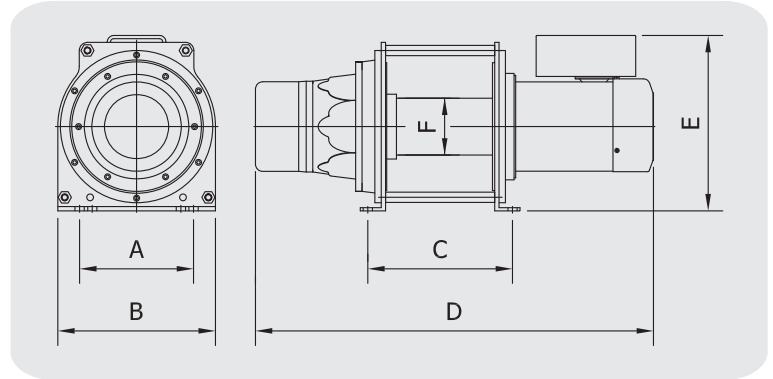

3 planetary gears with output shaft support feature minimum vibration, low noise and long service life.

SPECIFICATIONS

Model	Lifting Capacity	Speed(M/min)		Steel Rope	Voltage	Motor (KW)	Body Dimensions(mm)						N.W. (KG)	G.W. (KG)	Packing (L x W x H) (mm)
		50HZ	60HZ				A	B	C	D	E	F			
RC-1040-44F05	400KG	37	44	8mm x 50M	SINGLE PHASE 220 ~ 240V	3.7	160	250	206	703	298	105	68.2	70.0	797 x 270 x 325
RC-1050-21F05	500KG	18	21	8mm x 50M		1.8	160	250	206	703	298	105	65.7	67.5	797 x 270 x 325
RC-1050-25F10	500KG	21	25	8mm x 100M		2.0	202	292	265	751	328	101	91.5	93.5	800 x 297 x 370
RC-1100-21H03	1000KG	18	21	10mm x 30M		3.7	160	250	250	753	313	105	83.5	85.5	800 x 270 x 325
RC-3050-44F06	500KG	37	44	8mm x 60M	THREE PHASE 220 ~ 440V	3.7	160	250	250	747	298	105	71.2	73.0	797 x 270 x 325
RC-3050-25F10	500KG	21	25	8mm x 100M		2.0	202	292	265	751	328	101	91.5	93.5	800 x 297 x 370
RC-3050-50F10	500KG	42	50	8mm x 100M		3.7	202	292	265	751	328	101	91.0	93.0	800 x 297 x 370
RC-3050-25F15	500KG	21	25	8mm x 150M		2.0	202	292	395	881	328	101	103.0	105.0	913 x 297 x 370
RC-3050-50F15	500KG	42	50	8mm x 150M		3.7	202	292	395	881	328	101	106.0	108.0	913 x 297 x 370
RC-3070-21G05	700KG	18	21	9mm x 50M		2.2	160	250	225	779	298	105	86.5	88.5	797 x 270 x 325
RC-3070-25G08	700KG	21	25	9mm x 80M		2.2	202	292	265	783	328	101	100.0	102.0	800 x 297 x 370
RC-3100-25H06	1000KG	21	25	10mm x 60M		3.7	202	292	265	757	343	101	100.0	102.0	800 x 297 x 370
RC-3100-25H10	1000KG	21	25	10mm x 100M	3.7	202	292	395	887	343	101	120.0	122.0	913 x 297 x 370	

Product specifications and features are subject to change as a result of technological progress without prior notice.
Three phase motor is available.

PU SERIES ELECTRIC HOIST

3 - step speed reduction ratio



DIMENSIONS

unit: mm

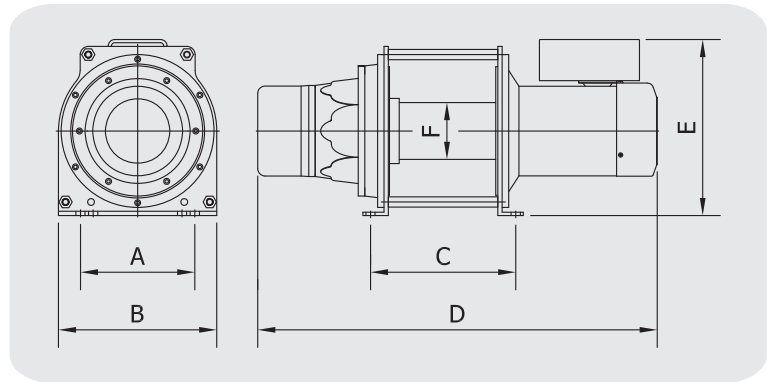

SPECIFICATIONS

Model	Lifting Capacity	Speed(M/min)		Steel Rope	Voltage	Motor (KW)	Body Dimensions(mm)						N.W. (KG)
		50HZ	60HZ				A	B	C	D	E	F	
PU-1070-09G07	700KG	7.5	9	9mm x 70M	SINGLE PHASE 220 ~ 240V	1.3	202	292	265	783	345	101	84.5
PU-1070-09G12	700KG	7.5	9	9mm x 120M		1.3	202	292	395	913	345	101	102.0
PU-1100-05H06	1000KG	4.0	5	10mm x 60M		1.3	202	292	265	783	345	101	86.5
PU-1100-09H10	1000KG	7.5	9	10mm x 100M		1.5	202	292	395	913	345	101	106.0
PU-1100-09H14	1000KG	7.5	9	10mm x 140M		1.5	260	390	373	891	345	168	160.0
PU-1150-05I05	1500KG	4.0	5	12mm x 50M		1.6	260	390	243	785	415	168	130.5
PU-1150-08I10	1500KG	6.5	8	12mm x 100M		2.0	260	390	373	915	415	168	170.5
PU-1200-05J03	2000KG	4.0	5	14mm x 30M		2.0	260	390	243	785	415	168	130.5
PU-1200-10J03	2000KG	8.0	10	14mm x 30M		3.7	260	390	243	785	415	168	136.0
PU-1200-07J07	2000KG	6.0	7	14mm x 70M		2.5	260	390	373	915	415	168	167.0
PU-3070-09G07	700KG	7.5	9	9mm x 70M	THREE PHASE 220 ~ 440V	1.3	202	292	265	783	345	101	84.5
PU-3070-09G12	700KG	7.5	9	9mm x 120M		1.3	202	292	395	913	345	101	102.0
PU-3100-05H06	1000KG	4.0	5	10mm x 60M		1.3	202	292	265	783	345	101	86.5
PU-3100-09H10	1000KG	7.5	9	10mm x 100M		1.5	202	292	395	913	345	101	106.0
PU-3100-09H14	1000KG	7.5	9	10mm x 140M		1.5	260	390	373	891	345	168	160.0
PU-3150-05I05	1500KG	4.0	5	12mm x 50M		1.6	260	390	243	785	415	168	130.5
PU-3150-08I10	1500KG	6.5	8	12mm x 100M		2.0	260	390	373	915	415	168	170.5
PU-3200-05J03	2000KG	4.0	5	14mm x 30M		2.0	260	390	243	785	415	168	130.5
PU-3200-10J03	2000KG	8.0	10	14mm x 30M		3.7	260	390	243	785	415	168	136.0
PU-3200-07J07	2000KG	6.0	7	14mm x 70M		3.0	260	390	373	915	415	168	173.0
PU-3300-07K05	3000KG	6.0	7	16mm x 50M	5.0	260	390	373	915	415	168	169.0	

Product specifications and features are subject to change as a result of technological progress without prior notice.
Three phase motor is available.

HAND WINCH & WORM GEAR WINCH

- Solid gear construction
- Black coated or Zinc plated finish
- Precise gear tooth engagement

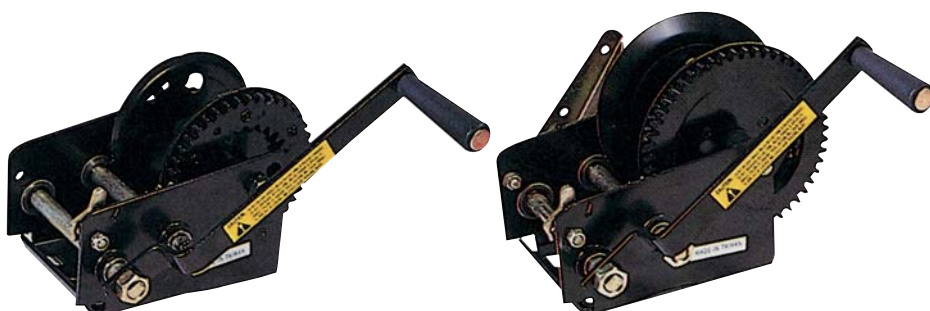

SPECIFICATIONS

ITEM NO.	CAPACITY	GEAR RATIO	PACK	N.W. (KG)	G.W. (KG)	CUFT	Q'TY
506	600 LBS / 270 Kgs	3 : 1	Box	20.0	21.0	1.4'	12
508	850 LBS / 385 Kgs	3 : 1	Box	22.0	23.0	1.4'	12
510	1000 LBS / 450 Kgs	4 : 1	Box	13.0	14.0	1.2'	6
512	1200 LBS / 545 Kgs	4 : 1	Box	14.0	15.0	1.2'	6
514	1400 LBS / 636 Kgs	4 : 1	Box	15.0	16.0	1.2'	6
516	1600 LBS / 727 Kgs	4 : 1	Box	17.0	18.0	1.2'	6
520	2000 LBS / 900 Kgs	4 : 1 / 10 : 1	Box	22.0	23.0	1.3'	4
525	2500 LBS / 1100 Kgs	5 : 1 / 12 : 1	Box	27.0	28.0	1.9'	4

15

- Solid steel gears
- Arc-welded for high strength construction
- Reinforced bases
- Black electro-plated finish
- Available in single or divided reel
- 7" Handle / Loop are both available

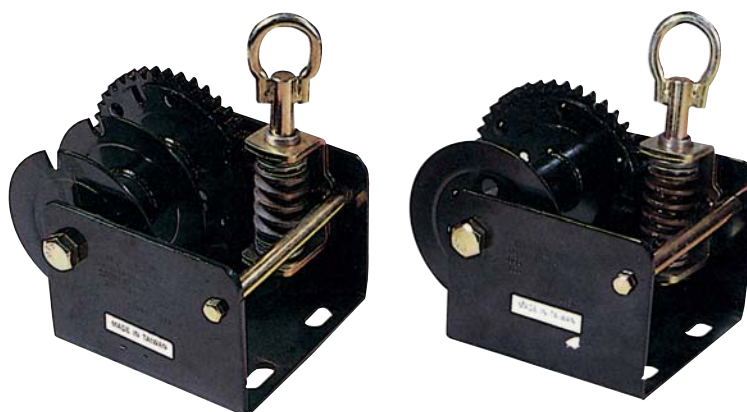

SPECIFICATIONS

ITEM NO.	CAPACITY	GEAR RATIO	REEL	HUB DIA	N.W. (KG)	G.W. (KG)	CUFT	Q'TY
615A	1500 LBS / 700 Kgs	31 : 1	Single	38 mm	24.0	25.0	1.62'	6
615B	1500 LBS / 700 Kgs	31 : 1	Divided	38 mm	24.0	25.0	1.62'	6
620A	2000 LBS / 900 Kgs	41 : 1	Single	38 mm	25.0	26.0	1.62'	6
620B	2000 LBS / 900 Kgs	41 : 1	Divided	38 mm	25.0	26.0	1.62'	6

Worm gear winches are used for applications such as raising and lowering pulley and livestock equipment, typically calling mounted.

CEMENT MIXER

This quality designed and manufactured CEMENT MIXER YM - 45 is excellent for application for wall and floor finishing and tile fixing. Ruggedly constructed zinc drum. Stainless steel drum is available. The drum can be set vertically for conveniently moving through the door. the mixing motion is transmitted through gear reducer for powerful operations.



- Ruggedly constructed throughout
- Convenient operation
- Economically priced

SPECIFICATIONS

Model: YM-45

Mixing capacity	Cement 1 bag Sand 3.5 times of cement
Motor	1ø220V 2.0H: / 3ø220V 3HP
Weight	110 kgs
Dimensions	95(L) x 92(W) x 103(H)cm
Mixing drum	87(Dia) x 35(H)cm

Product specifications and features are subject to change as a result of technological progress without prior notice.

ACCESSORIES

BRACKET



SY-A

Wall clamp bracket

W 880mm x H 1800mm

suitable
hoisting
weight
250 kgs.



SY-T

Three stage vertical bracket

W 1220mm x H 2500mm

suitable
hoisting
weight
300 kgs.



SY-X

X reinforced bracket

W 1160mm x H 2400mm

suitable
hoisting
weight
600 kgs.

17

WEIGHT HOOK



PL - 950



TW - 830



DR - 820



TW - 840



MINI WINCH ONLY

PUSH-BUTTON SWITCH

DIRECT SWITCH TYPE



KOB - 213 KOB - 22 KOB - 23 KOB - 213A

INDIRECT SWITCH TYPE



KOB - 61 KOB - 62 KOB - 63 KOB - 803

QUICK CONNECTOR

Input Type

Sheet Size	No. of Contacts
20	2P, 3P, 4P, 7P
24	10P
28	12P, 16P, 20P, 26P
35	24P

Output Type

Sheet Size	No. of Contacts
20	2P, 3P, 4P, 7P
24	10P
28	12P, 16P, 20P, 26P
35	24P

Output Type

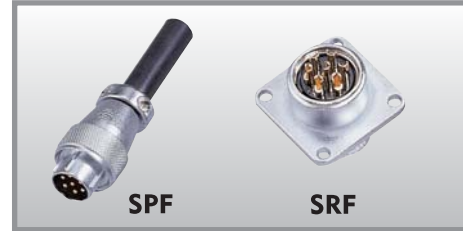

Input Type

Sheet Size	No. of Contacts
19	2P, 3P, 4P
25	2P, 3P, 4P, 5P
30	2P, 3P, 4P, 5P
40	4P, 8P

Output Type

Sheet Size	No. of Contacts
25	2P, 4P
30	4P, 7P
40	4P

Input Type



Output Type



CART



BC-100
BC-120
BC-160



SC-145
SC-240
SC-334



EC-125

BRIDGE RECTIFIER

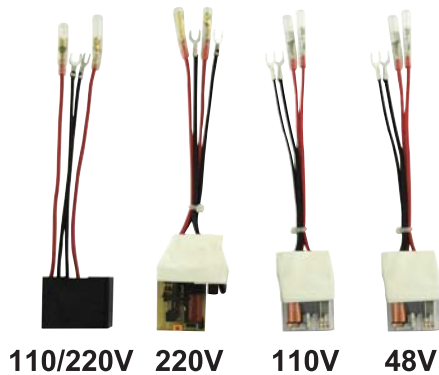

SY-H

